

Duct Inserted Type

DSD

CO₂ Sensor



■ Sensor Type

Measurement Range	Output	Model
0 to 2000ppm	4 to 20 mA DC	DSD-101-CO2-1A
	1 to 5 V DC	DSD-101-CO2-1V
0 to 5000ppm	4 to 20 mA DC	DSD-101-CO2-2A
	1 to 5 V DC	DSD-101-CO2-2V

■ Specifications

Output	1 to 5 V DC, 4 to 20 mA DC (must be specified.)
Supply Voltage	24 V DC \pm 10%
Accuracy	\pm 30ppm (\pm 5% of indicated value)
Response Characteristics	Within 1 minute (at 1.5m/s wind velocity)
Dimensions	W100 x H133 x D260 mm
Mounting	Adjustable flange DSDF-SQ80 recommended (sold separately)
Power Consumption	18 W
Operating Environment	Temperature: 0 to 50°C Humidity: 5 to 95%RH (non-condensing) [Caution] Do not use this sensor in an environment where dew condensation occurs. Do not use this sensor in an environment where chlorinated and sulfidizing gases are being generated.
Storage Environment	Temperature: -20 to 60°C Humidity: 5 to 95%RH (non-condensing)
Weight	Approx. 400g

■ Terminal Arrangement

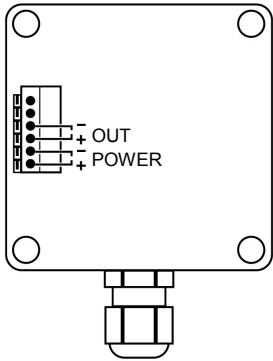

OUT: Output 1 to 5 V DC or 4 to 20 mA DC (must be specified.)

POWER: Power supply voltage 24 V DC

[Caution] Do not reverse polarity.

■ External Dimensions (Scale: mm)

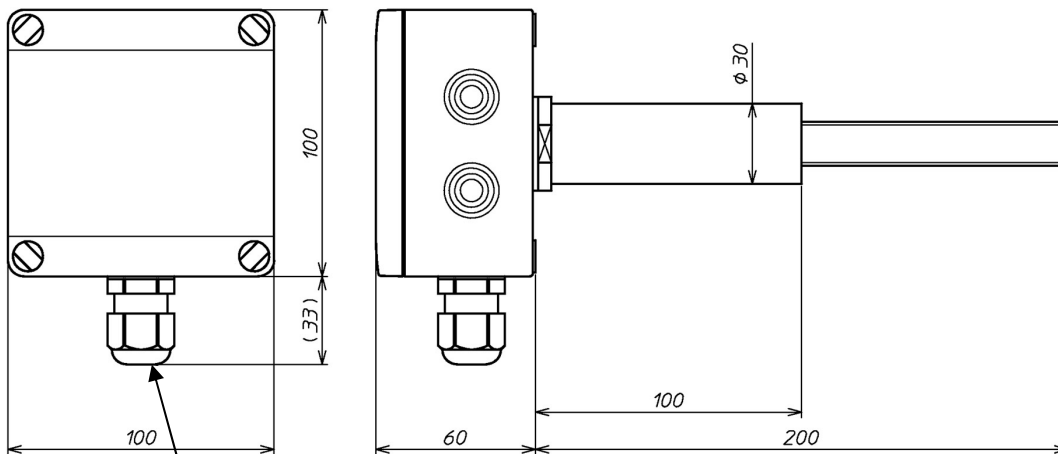

Compatible electric wire diameter: ϕ 6 to 10